

Inductive displacement sensor

Sensor with build electronic for direct outputs as:
4..20mA, 2 wire, 0..10V, 0..5V & 0..4Volt
Data according to Data sheet SM34

Series **SM34 .LPxU**

- radial cable output
- cable length x m
- PUR cable 3x 0,14²

Dimensions in mm

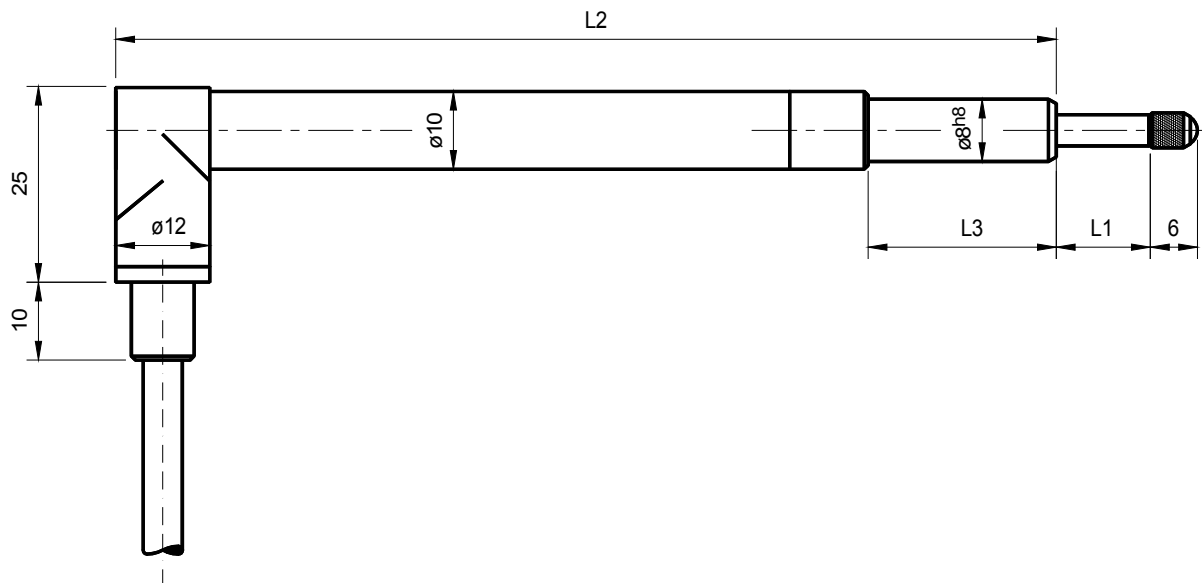

Stroke mm	L2 mm	L3 mm	Plunger in mid-position L1 mm ± 1 mm	Extended plunger L1 mm
5	109	24	7	12
10	120	24	6	12
15	138	32	11	22
20	142	32	11	22

Electrical connections:

Voltage output	Current output	.LP PUR cable 3x0,14 ²
+UB	+JB	brown
-UB	Not connected	white
UA	-JB	green

Other data according to datasheet **SM34** Contact: Nordic Transducer e-mail: ntt@ntt.dk