

Type K- 100

Tension miniature force sensor

- miniature transducer
- very small dimensions
- stainless steel
- low weight
- ranges from 1...100 kN

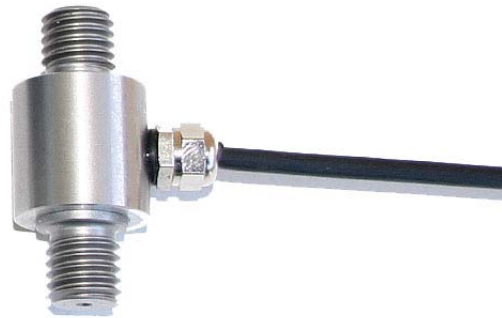

Wire connection	
<i>supply(-)</i>	<i>green</i>
<i>supply(+)</i>	<i>brown</i>
<i>sign(+)</i>	<i>yellow</i>
<i>sign(-)</i>	<i>white</i>
<i>calibration control (option)</i>	<i>grey</i>
<i>shield</i>	<i>shield</i>

Dimensions

K-100

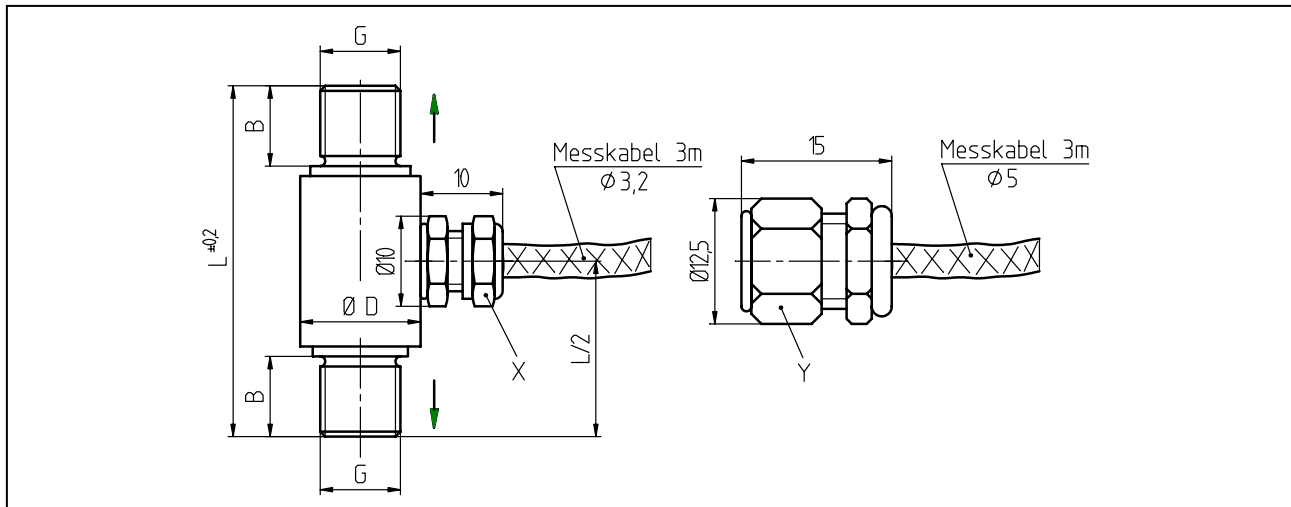

Nominal load [kN]	L	G	D	B	X	Y
1/2	35	M5	10	8	x	-
5	35	M8	12	8	x	-
10	40	M10	18	10	x	-
20	45	M12	24	12	x	-
50	50	M16	29	15	x	-
100	70	M24x2	35	20	-	x

specifications

TYPE	K-100	
nominal load	kN	1 / 2 / 5 / 10 / 20 / 50 / 100
accuracy class	S%	0,3
service load	S%	130
limit load	S%	150
ultimate load	S%	>300
max. dyn. load (DIN 50 100)	S%	70
position feedback	mm	< 0,1
bridge resistance	Ω	350
insulation resistance	Ω	> $2 \cdot 10^9$
supply voltage	V	2 ...12 [<10 kN; 2...6]
max. supply voltage	V	12 [<10 kN; 8]
sensitivity (S)	mV/V	0,8 ...1,2
tolerance of sensitivity	S%	$\pm 0,3$
temp. coeff. of sensitivity	S%/10K	$\pm 0,2$
temp. coeff. of zero	S%/10K	$\pm 0,2$
reference temperature	$^{\circ}\text{C}$	23
nominal temp. range	$^{\circ}\text{C}$	0 ...+50
service temp. range	$^{\circ}\text{C}$	-10 ... +60
storage temperature range	$^{\circ}\text{C}$	-30 ...+90
combined error	S%	0,25
creep error	S%/30min	< $\pm 0,1$
level of protection (DIN 40 050)	IP 65	
material	stainless steel	
cable	3 m, freie Litze – free wires	

options

Sensor interface Type LCV 0...10 V bzw. - or 0(4)...20 mA	LCVU bzw. - or LCVI
---	---------------------

Please specify requested nominal load at order !

NTT instrumentation does cover the whole range from analog excitation units to high speed instruments + also battery based units as the DFI shown here.



Analog & Digital amplifiers for all types of jobs



DFI battery based instrumentation

USB to PC excitation unit

