

Double-Ended Shear Beam Load cell Model: DCO-3 from 10 - 25ton

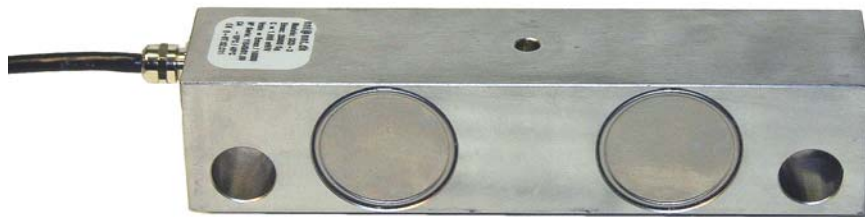
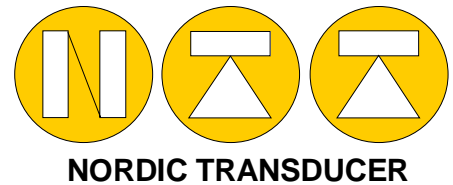

The **DCO-3** is a mid to high capacity stainless steel double ended shear beam load cell designed for use in industrial and outdoor environments.

Stainless steel construction limits corrosion from outdoor use and the IP67 sealing makes it suitable for applications that are subject also to wash down.

Tank weighing is made simple when this load cell is combined with the mounting hardware units special design for this cell.

Its high accuracy (up to OIML C6) make it ideal for certified weighing of many kind.

This load cell can also be supplied ATEX approved, making it suitable for use in potentially explosive environments.

DCO-3 load cell



Rated capacity:	10, 15, 20, 25 ton
OIML R60, class:	C3,C4,C5,C6
Maximum combined error:	<0.02%
Repeatability error:	<0.02%
Creep (30min)	<0.02%
Zero Temp. effect:	<0.003%/°C
Output Temp. effect:	<0.0008% °C
Temperature limits:	-10°C - +40°C
Rated output:	2 +/- 0,1% mV/V
Excitation Voltage:	5 - 15V
Input Resistance:	700 +/-30hm
Output resistance:	700 +/-3 Ohm
Protection against humidity :	IP67 (DIN 40050)
Material load cell:	Stainless steel
Cable 6 wire:	15m
Maximum service load:	120%
Maximum load:	150%

CE Certification: E-97.02.C11

PM7.0-DCO_3/DCO-3.PMD100718

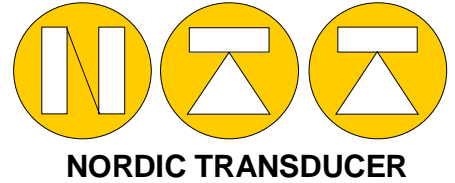

DCO-3 load cell supports

DCO-3 in stainless steel IP67 protection.

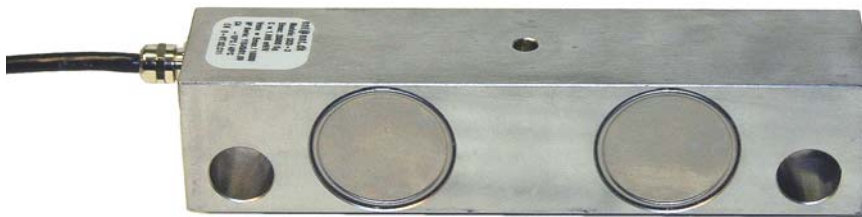

Dimensions in mm

Weight = 4.44kg

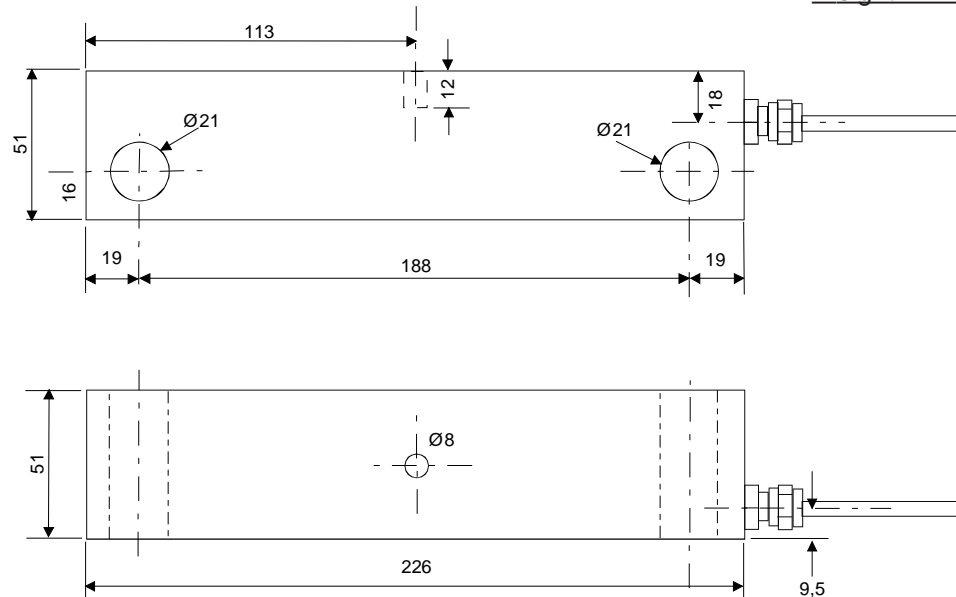

6 wire system cable Ø6,5 x 15m length

Exc +	= Red
Sense +	= Yellow
Exc -	= Black
Sense -	= Blue
Signal +	= Green
Signal -	= White

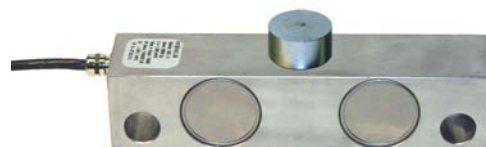

DCO-3 load cell supports

Base support for **DCO-3** load cell, can be supplied in nickel plated steel or stainless steel.

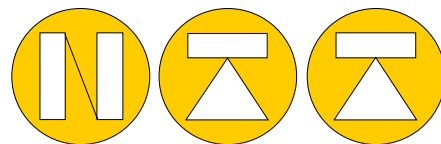

NORDIC TRANSDUCER

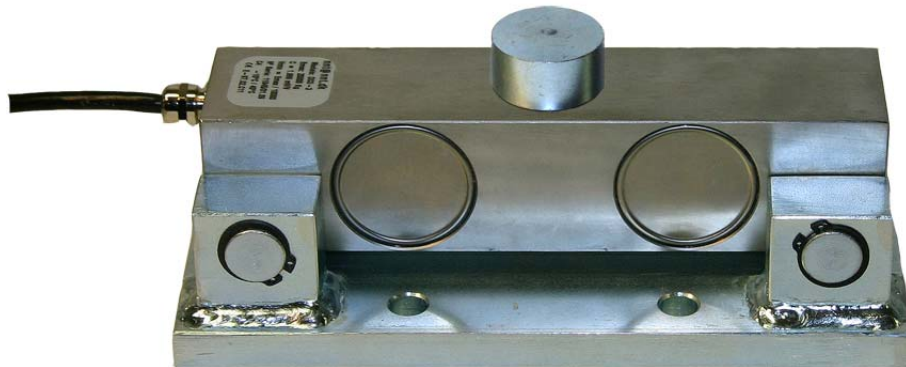

Weight = 9.33kg

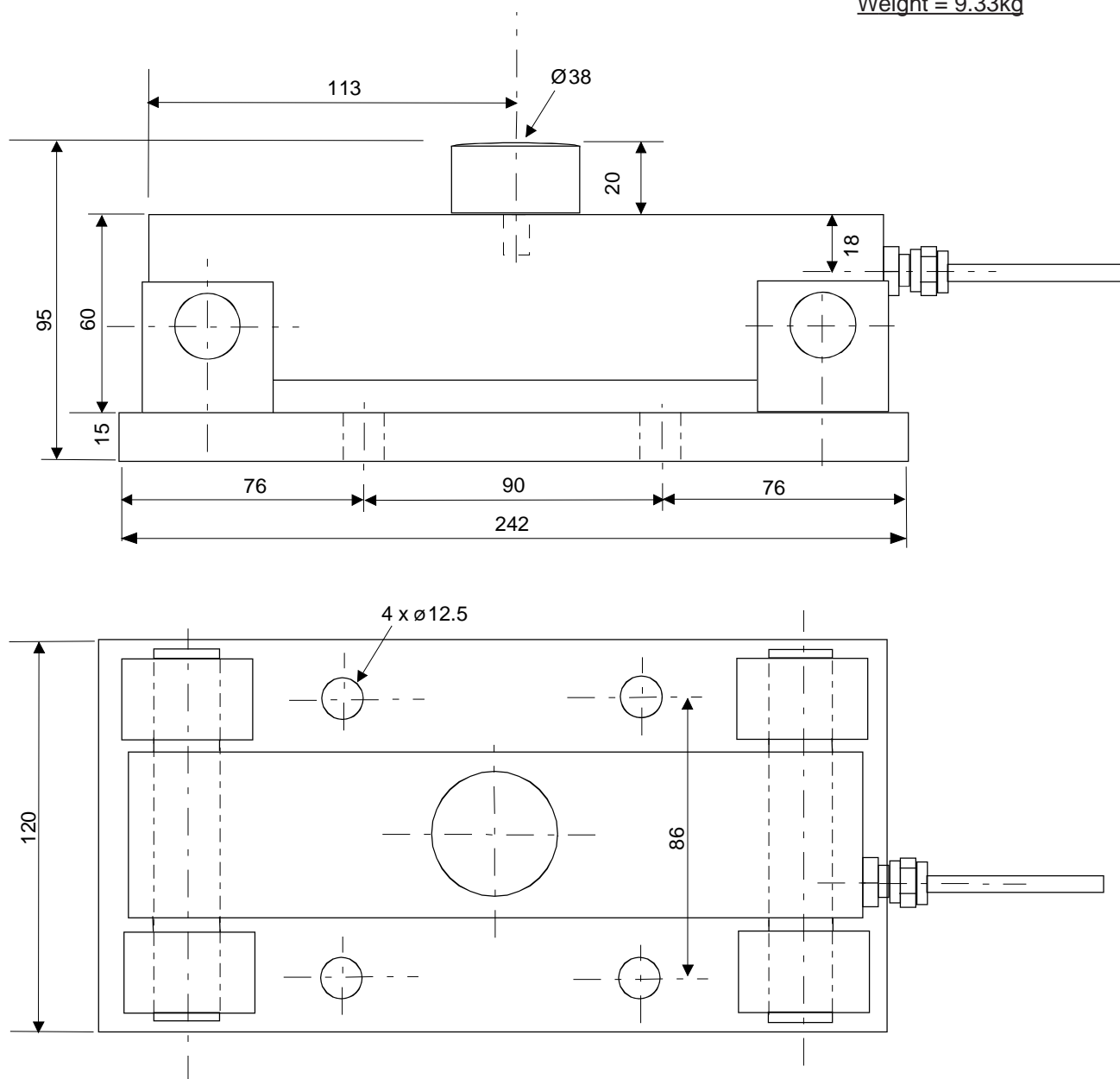

PM7.0-DCO_3/DCO-3.PMD100718

TA tank support for **DCO-3** load cell, can be supplied in nickel plated steel or in stainless steel.

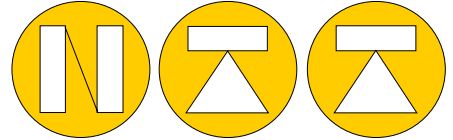

NORDIC TRANSDUCER

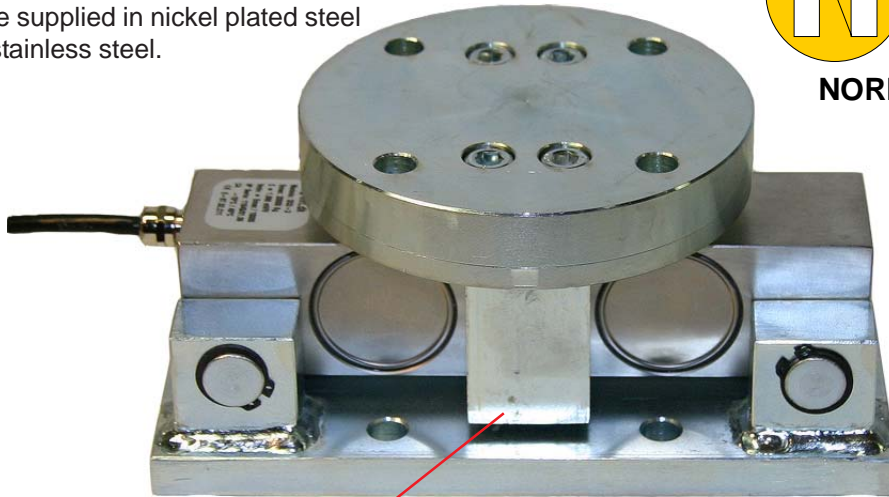

Uplifting protection $\varnothing 148$

Total weight = 13.70kg

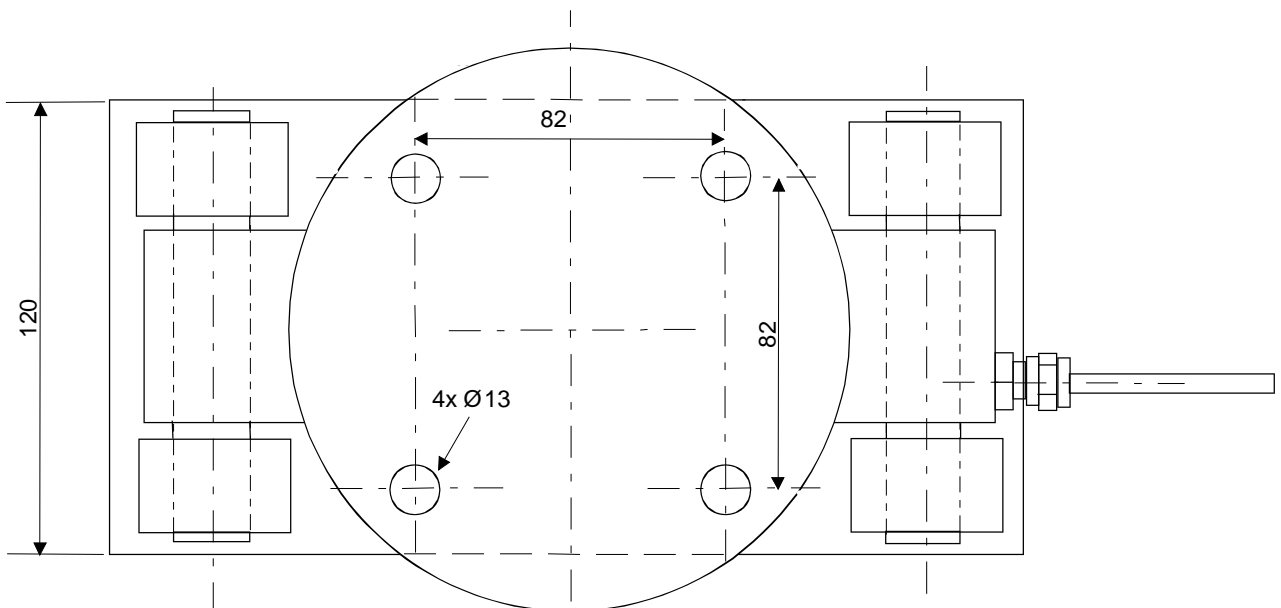
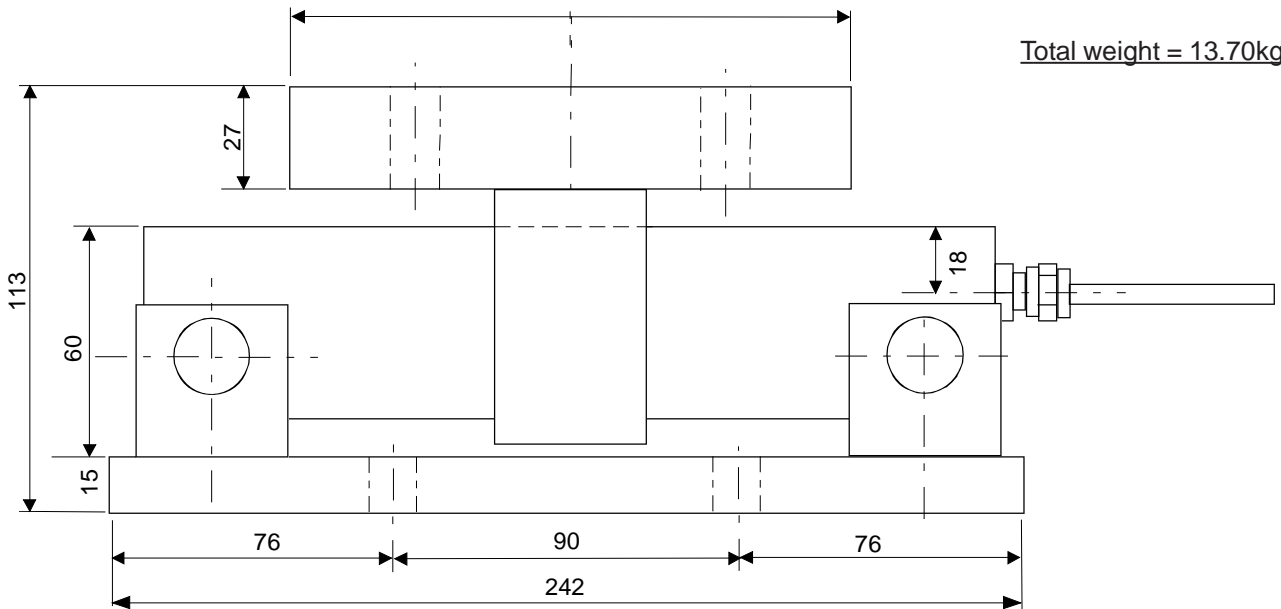

PM7.0-DCO_3/DCO-3.PMD100718