

ASC COMPRESSION LOAD CELL



DESCRIPTION:

The ASC is a single column, stainless steel compression load cell

This product is suitable for use in road and rail weighbridges and process weighing applications.

The welded construction and built-in surge protection ensure that this product can be used successfully in harsh environments.

FEATURES:

- Self-aligning, stainless steel single column
- Hermetically sealed, IP66 and IP68
- Certified to OIML R60, **6000d**
- Built-in surge protection tubes (GDTs)
- Current calibration output (SC) ensures easy and accurate parallel connection of multiple load cells
- Digital version available (model DSC)
- **Capacities: 30, 40 and 50t²**

ASC: SPECIFICATIONS

Capacity	E _{max}	t	30, 40, 50				
			C3	C4	C5	C6	
Accuracy Class According to OIML R60							
Maximum Number of Verification Intervals	n _{ic}		3000	4000	5000	6000	
Minimum Verification Interval (v _{min} = E _{max} /Y)	v _{min}		E _{max} /6000	E _{max} /8000	E _{max} /10000	E _{max} /12000	
Minimum Verification Interval, Type MR	v _{min}		E _{max} /15000	E _{max} /16000	E _{max} /25000	E _{max} /30000	
Accuracy Class According to Type Designation ¹			CC	C3	C4	C5	C6
Combined Error		%S	≤ ± 0.050	≤ ± 0.023	≤ ± 0.018	≤ ± 0.014	≤ ± 0.012
Hysteresis		%S	≤ ± 0.050	≤ ± 0.017	≤ ± 0.013	≤ ± 0.010	≤ ± 0.008
Minimum Dead Load Output Return	MDLOR	%S	≤ ± 0.050	≤ ± 0.017	≤ ± 0.013	≤ ± 0.010	≤ ± 0.008
Minimum Dead Load Output Return, Type MI7.5	MDLOR	%S _{nom}		≤ ± 0.0067	≤ ± 0.0067	≤ ± 0.0067	
Non-Repeatability	E _R	%S	≤ ± 0.070	≤ ± 0.035	≤ ± 0.026	≤ ± 0.021	≤ ± 0.018
Creep Error (30 Minutes)		%S	≤ ± 0.060	≤ ± 0.025	≤ ± 0.018	≤ ± 0.015	≤ ± 0.012
Creep Error (20-30 Minutes)		%S	≤ ± 0.0200	≤ ± 0.0053	≤ ± 0.0039	≤ ± 0.0032	≤ ± 0.0026
Temp. Effect on Minimum Dead Load Output	TC _o	%S _{nom} /5°C	≤ ± 0.0250	≤ ± 0.0117	≤ ± 0.0088	≤ ± 0.0070	≤ ± 0.0058
Temp. Effect on Minimum Dead Load Output, Type MR	TC _o	%S _{nom} /5°C		≤ ± 0.0047	≤ ± 0.0044	≤ ± 0.0028	≤ ± 0.0023
Temperature Effect on Sensitivity	TC _s	%S/5°C	≤ ± 0.0250	≤ ± 0.0088	≤ ± 0.0065	≤ ± 0.0053	≤ ± 0.0045
Minimum Dead load	E _{min}	%E _{max}	0				
Safe Load Limit	E _{lim}	%E _{max}	150				
Ultimate Load	E _{ult}	%E _{max}	300				
Deflection at E _{max}		mm	0.50				
Excitation Voltage		V	5 ... 20				
Maximum Excitation Voltage		V	25				
Rated Output	S _{nom}	mV/V	2 ± 0.02				
Current Calibration	SC-version		Standard				
Zero Balance		%S _{nom}	≤ ± 1.0				
Input Resistance	R _{in}	Ω	700 ± 35				
Output Resistance	R _{out}	Ω	700 ± 7				
Insulation Resistance	R _{ins}	MΩ	≥ 5000				
Compensated Temperature Range	T _{cps}	°C	-10 ... +40				
Operating Temperature Range	T _{opr}	°C	-40 ... +80				
Storage Temperature Range	T _{strg}	°C	-50 ... +90				
Element Material			Stainless steel 1.4542				
Sealing (DIN 40.050 / EN 60.529)			IP66 and IP68				

1 The specified accuracies apply for the compensated temperature range.

2

SC-version: The rated output and the output resistance are balanced in such a way, that the output current is calibrated to within 0.05% of a reference value. This allows easy parallel connection of the load cells.

Correct mounting of the load cells is essential to ensure optimum performance.
Further information is available on request.

Cable specifications:

Cable length 15m

Excitation +	Green
Excitation -	Black
Output +	White
Output -	Red
Shield	Transparent

Shield is not connected to the load cell body.
All dimension tolerances according to ISO 2768m, unless otherwise specified.

Also available:

Self Aligning Set ASC and DSC 30t

For more information:

Assembly Guideline 02/3-110/01.

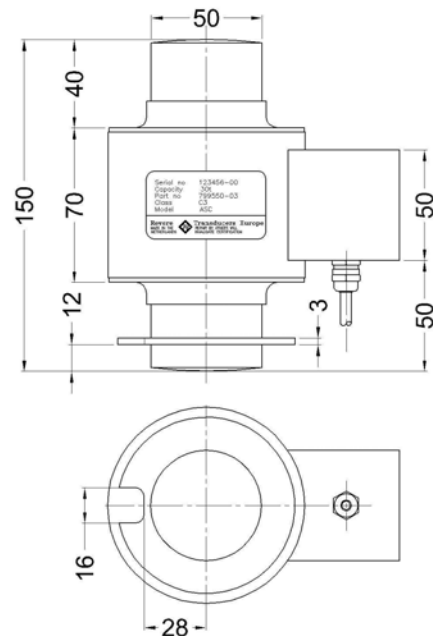

All specifications subject to change without notice.

REVERE TRANSDUCERS EUROPE
Als-Oddevej-85 DK9560

NORDIC TRANSDUCER DENMARK
Hadsund Denmark

Tel.: (+45) 98 58 14 44
Fax.: (+45) 98 18 18 66
E-mail: ntt@ntt.dk
Website: www.ntt.dk